



Ontario Place Revitalization Public Consultation

April 15, 2023

Ontario Place Throughout History

1960s
WATERFRONT INFILL



Source: Toronto Public Library.

1970
ZEIDLER PODS NEAR COMPLETION



Source: Toronto Public Library.

1971
FREE CONCERT AT THE FORUM



Source: Toronto Public Library.

1986
WILDERNESS ADVENTURE



Source: Toronto Public Library.



Source: Wikicommons.



Source: Toronto Public Library.



Source: Toronto Public Library.



Source: Toronto Public Library.



Source: Vintage Toronto.

time immemorial
HISTORY OF INDIGENOUS SETTLEMENT

1968 - 1970
ORIGINS AND CONSTRUCTION

1971 - 1978
OPENING DAY AND CHILDREN'S PLAY

1980s
ONTARIO NORTH NOW AND WILDERNESS ADVENTURE

early 1990s
EXPANDING THE ISLAND AND PARK PROGRAMMING

Ontario Place Throughout History

1996

CHILDREN'S VILLAGE WATERSLIDES



Source: Toronto Public Library.

2000

BUMPER BOATS



Source: Toronto Public Library.

2005

CINESPHERE IMAX THEATRE



2010

SEASONAL FLOODING

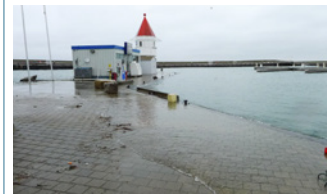

Source: Toronto Public Library.

mid-1990s

INTERNATIONAL RECOGNITION AND AMPHITHEATRE EXPANSION



Source: Toronto Public Library.

2000s

SOAK CITY AND THE EXPANDING CENTRAL WATERFRONT

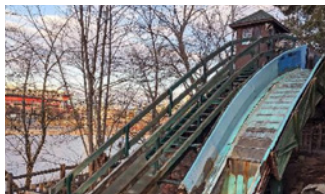

early 2010s

CLOSURE AND REVITALIZATION EFFORTS



late 2010s

TRILLIUM PARK AND THE WILLIAM G DAVIS TRAIL



2019

CALL FOR REDEVELOPMENT

The Team

Infrastructure Ontario

Applicant

Urban Strategies Inc.

Overall Master Plan and Approvals

LANDinc

East Island and Mainland Design

Martha Schwartz Partners

East Island and Mainland Design

Therme Canada

West Island Design

Diamond Schmitt Architecture

West Island Design

STUDIO tla

West Island Design

Baird & Associates

West Island Shoreline Engineers

SLR Consulting

Shoreline and Terrestrial Ecology

Morrison Hershfield

Shoreline and Terrestrial Ecology

Shoreplan Engineering

Shoreline Consultant

ERA Architects Inc.

Heritage Consultant

LEA Consulting

Transportation Consultant

Process and Engagement Update

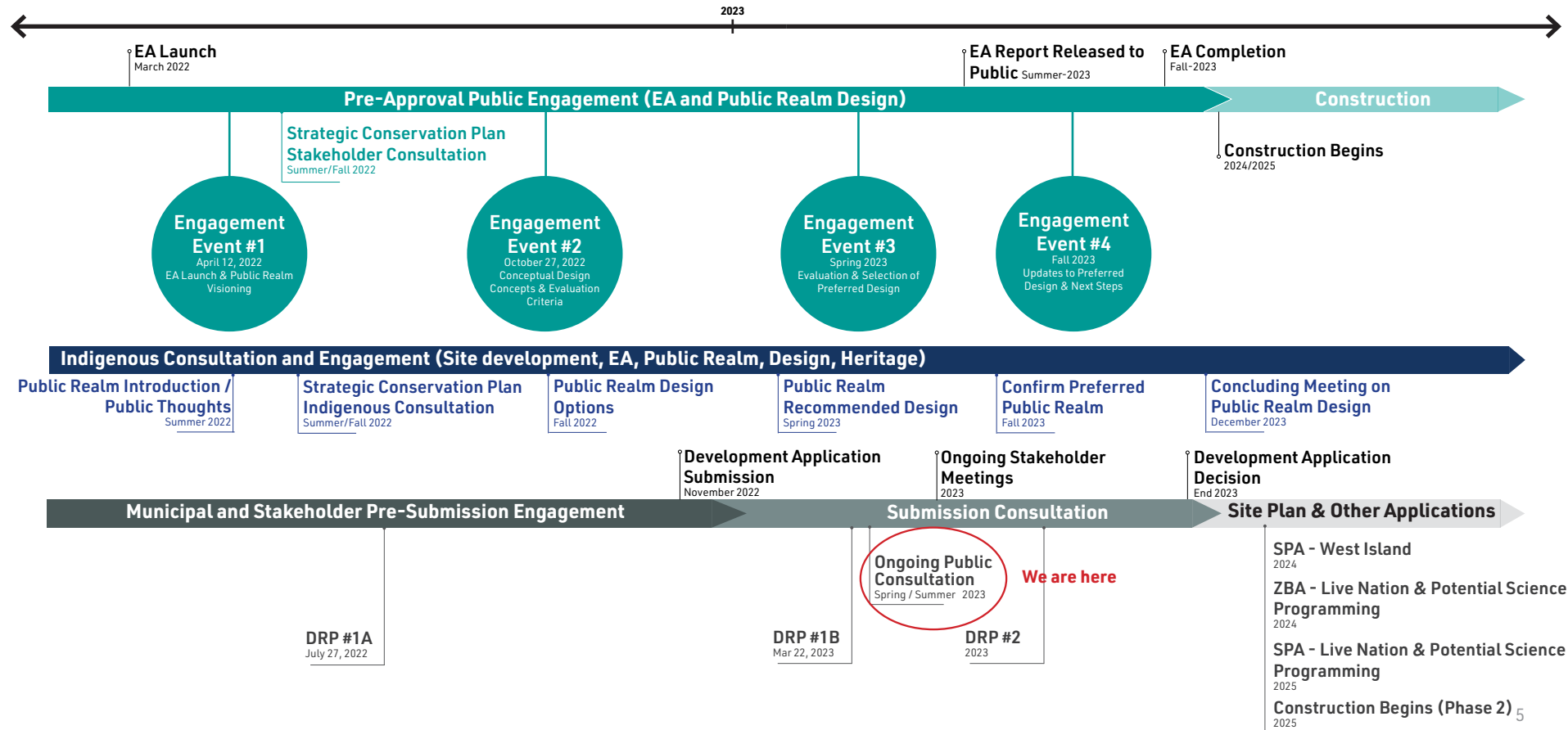

Today's Challenges

Flooding



Impermeable Surfaces



Accessibility



Poor Water Quality



Shoreline Degradation



Parking + Circulation



Soil + Environmental Conditions

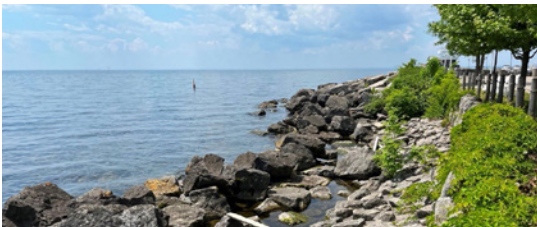

Harsh Weather Conditions



Limited Seasonal Uses



Connecting the Waterfront Open Space Network



Connecting Ontario Place and Entertainment



Enercare Centre



BMO Field & Festival Plaza



Beanfield Centre

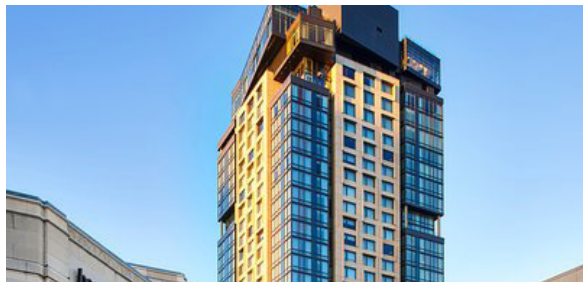

Hotel X & E-Sports



Coca-Cola Coliseum



Canadian National Exhibition

Ontario Place Revitalization Opportunities

Creating Year-Round Destinations



Re-imagining the legacy of Ontario Place



Inviting all Ontarians





The Vision for Ontario Place

Ontario Place Revitalization Ambitions



Green Space

Important New
Public Open Spaces



Access

Preserve A Publicly
Accessible Waterfront



Water

Increased
Water Access



Wetlands

New Aquatic
Habitat And Wetlands



Trees

Increased
Canopy Coverage

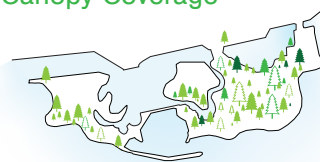

Bike Paths

New and Improved
Multi-use Trails





**New green space and
a continuous public
waterfront access**

*Approximately 50 acres of new
and improved public open
space*

Expanded tree canopy and wetland habitat

Approximately 3,000+ new trees and 100+ new mature trees to be preserved





**Extending the William
G. Davis Trail across
the island**

*Approximately 2.5 km of new
and improved paths*



**A safe, resilient and
accessible shoreline for
future generations**

*6+ acres of new aquatic wetland
and habitat*



New family-friendly destinations

Forecast to attract up to 6 million annual visitors from across the province and around the world



Conceptual design, subject to change.

Ontario Place Revitalization Ambitions

Setting the Structure for Redevelopment

#1: Restore and enhance the water's edge and secure continuous public access



#2: Integrating Ontario Place with Exhibition Place and the city beyond

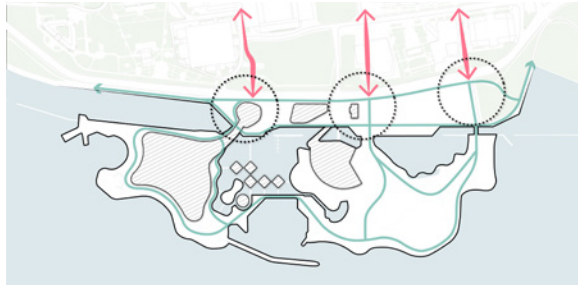

#3: Prioritize rehabilitation of the Cinesphere and Pod complex as a focus for heritage renewal



#4: Enhance long-term resilience, environmental performance and sustainability



#5: Upgrade the public spaces and beach, and create new and expanded waterfront parks



#6: Deliver exciting programming year round



Structuring Element #1:

Restore and enhance the water's edge and secure continuous public access

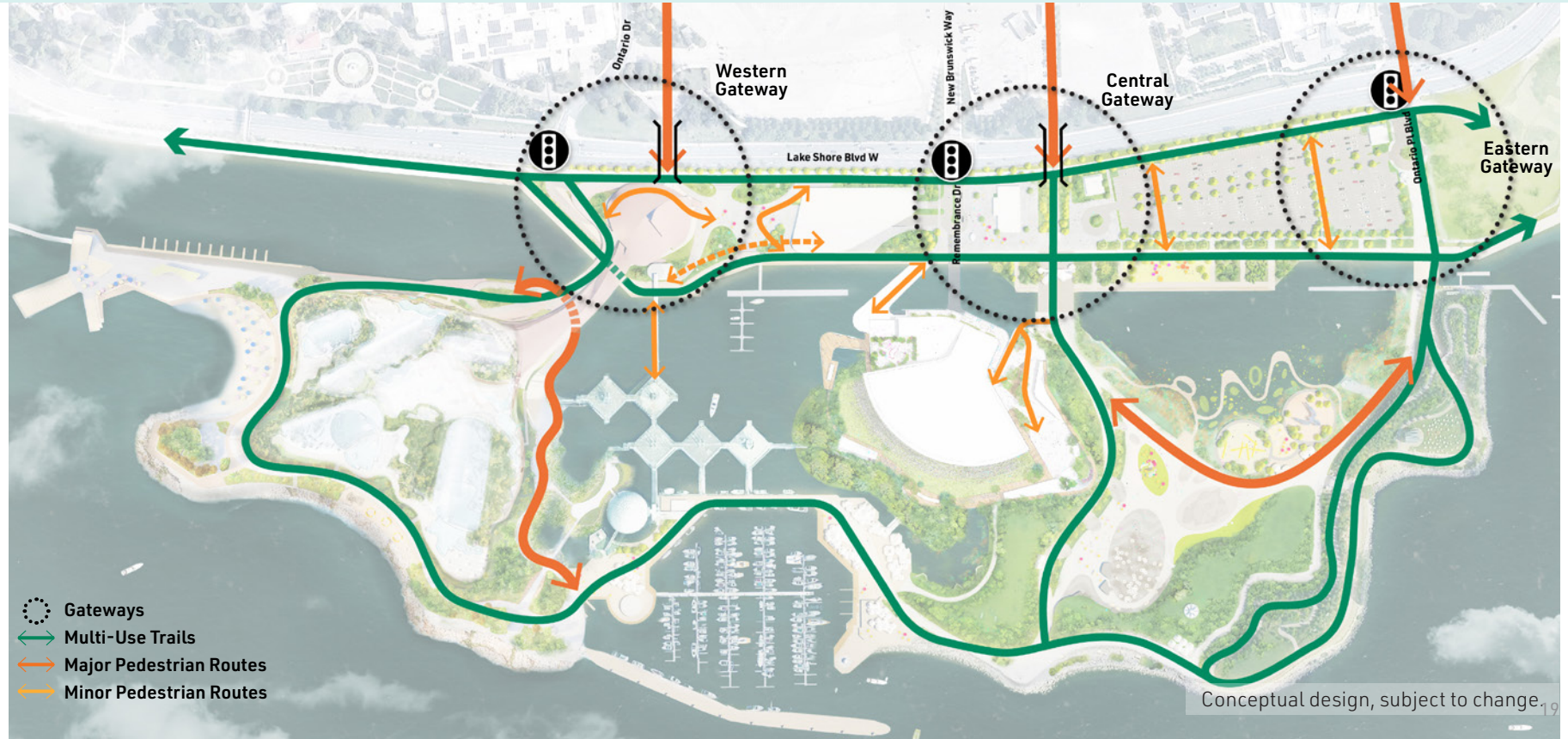

The Mainland: Existing Condition



A New Waterfront Promenade on the Mainland



Conceptual design, subject to change.

South Shore: Existing Context

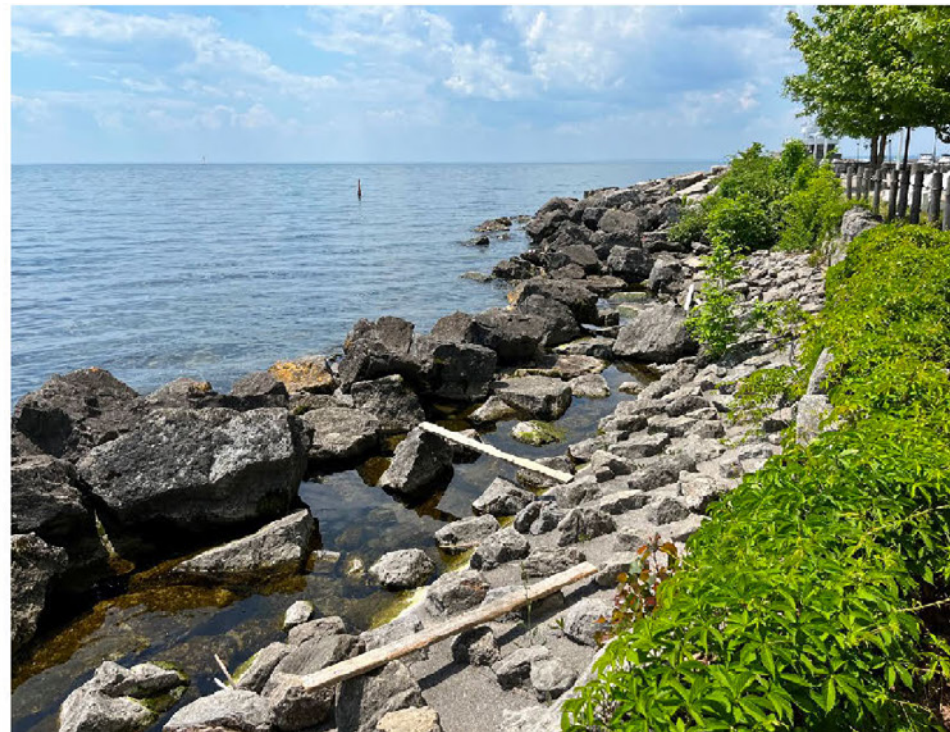

Increasing Access to the Water's Edge on the South Shore



Conceptual design, subject to change.

Improving Water Access for All

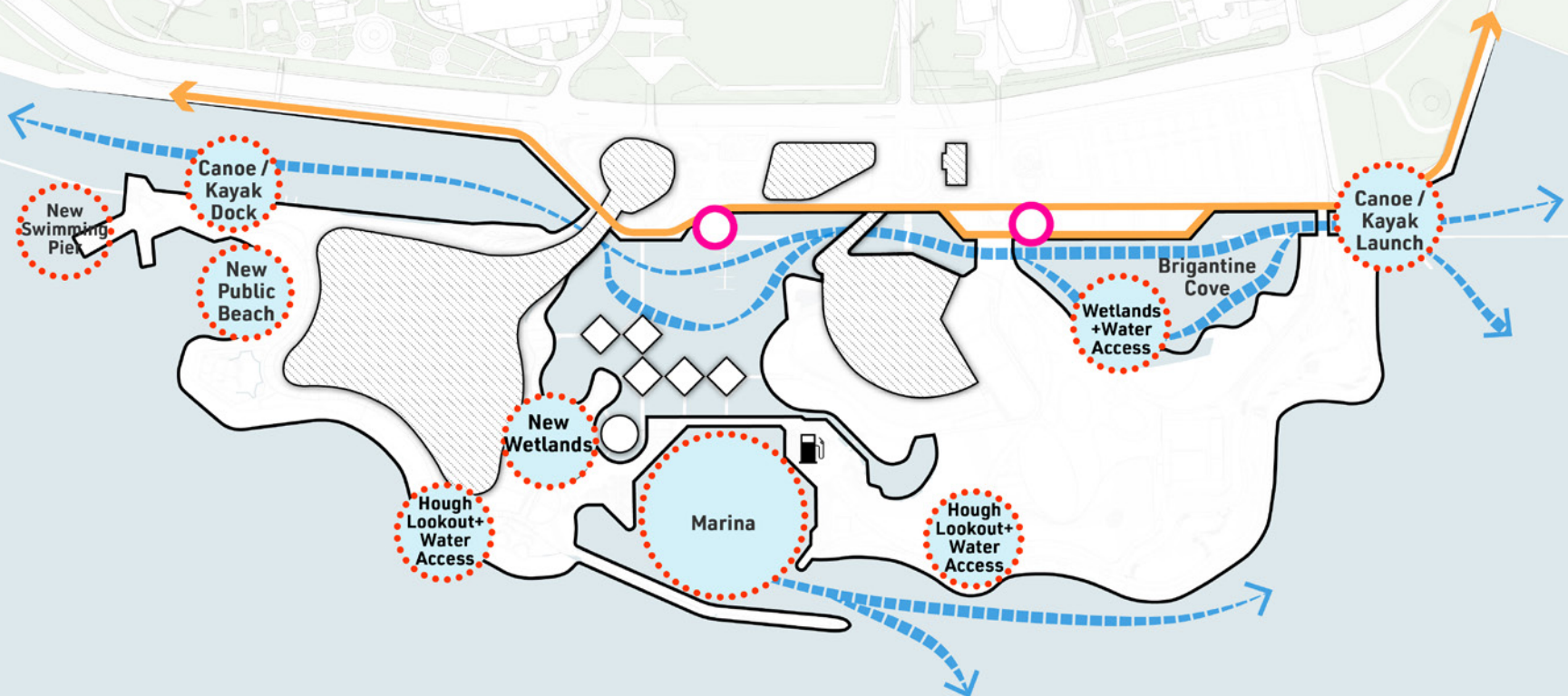

A New Bridge to Improve Access to the East Island

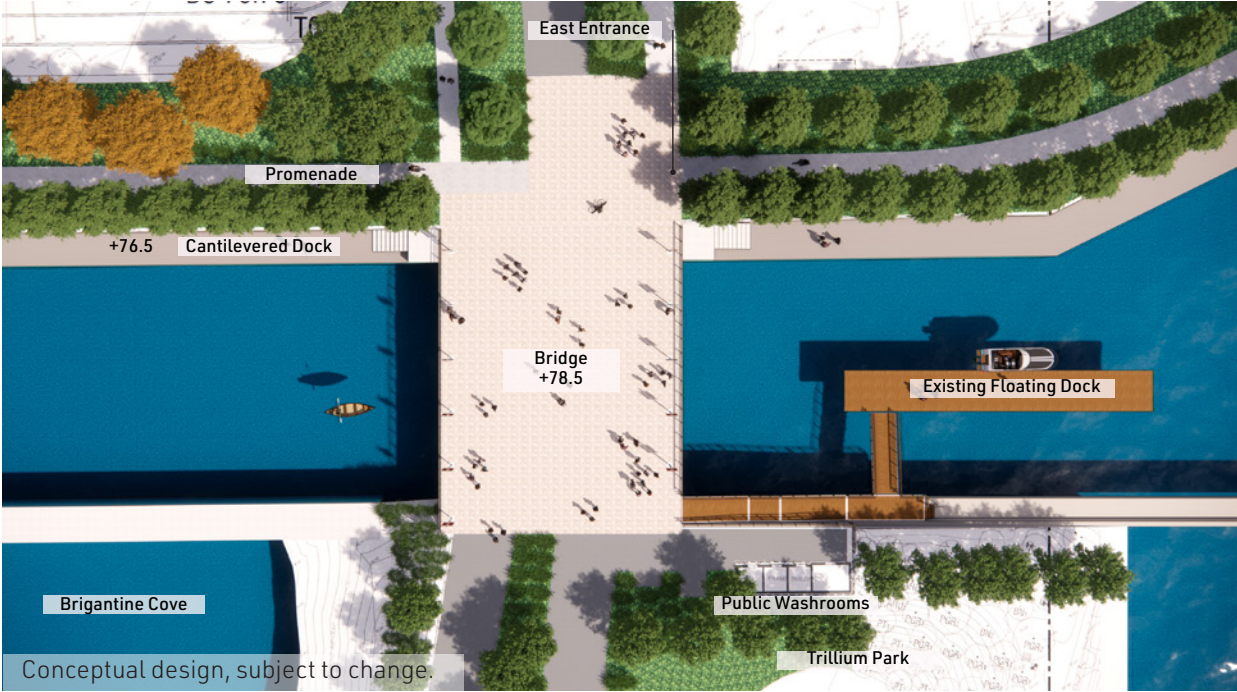

Structuring Element #2: Integrating Ontario Place with Exhibition Place and the City Beyond

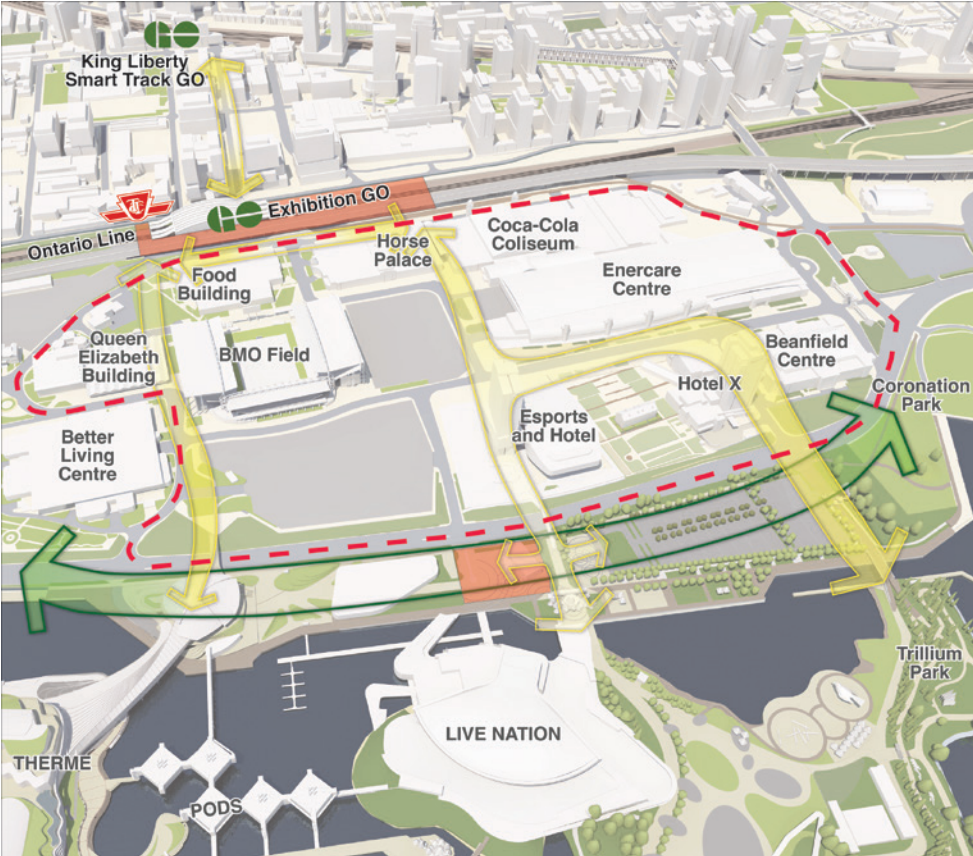

Planning for Future Connections to Exhibition GO

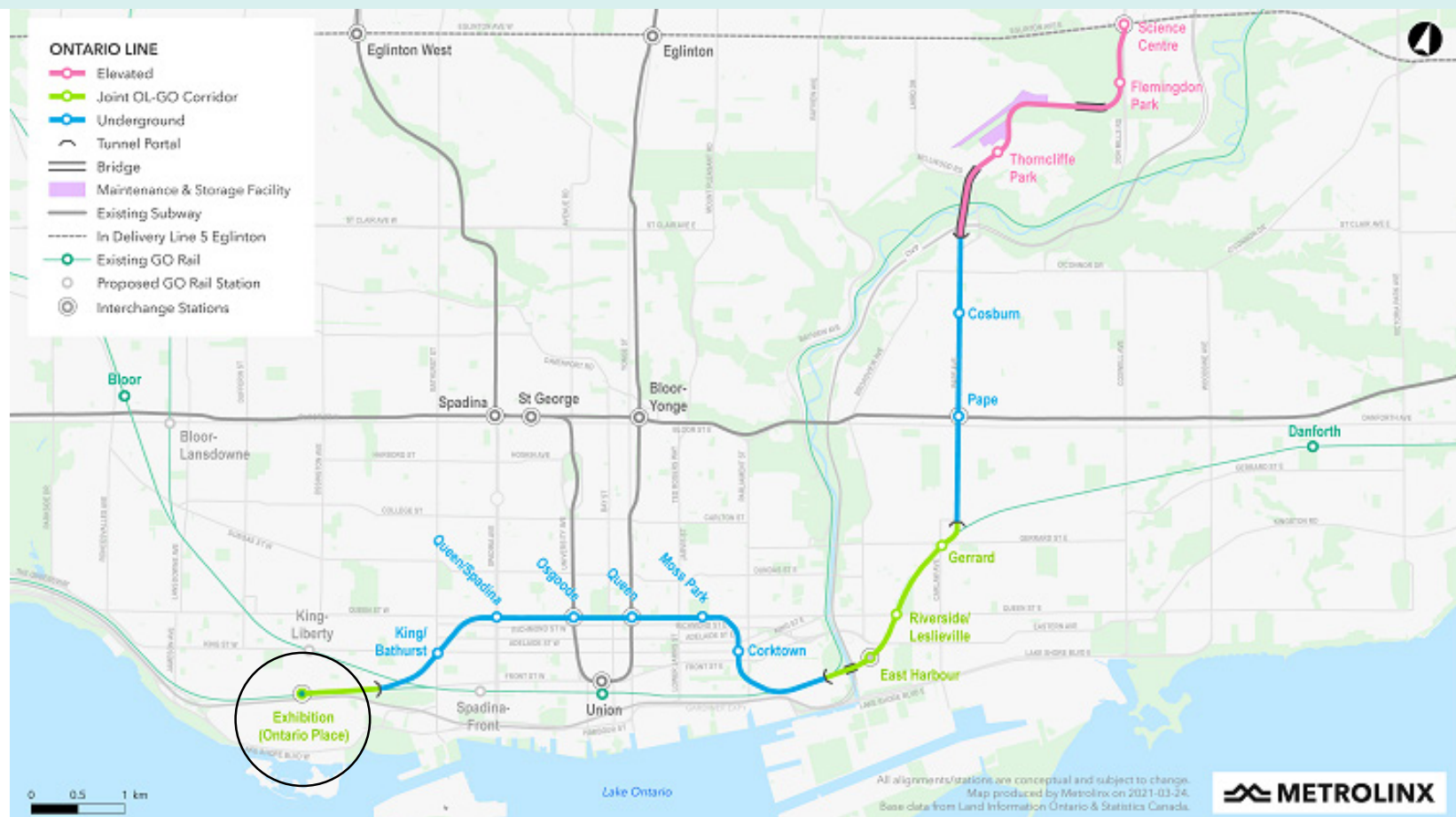

Improving Mainland Access and Circulation

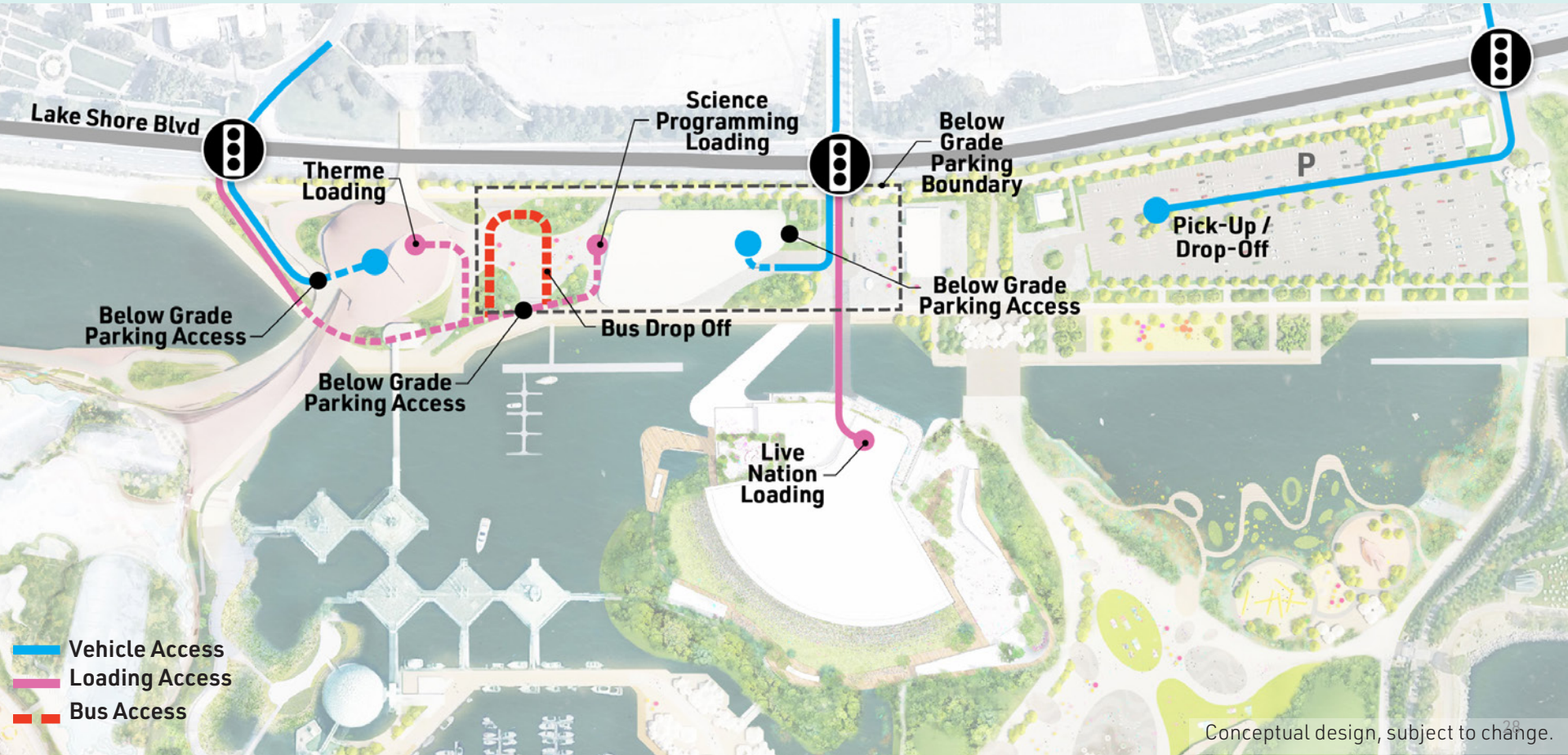

Improving Public Access to Ontario Place



Integrating Public and Ticketed Access on the West Island



Structuring Element #3:

Prioritize rehabilitation of the Cinesphere and Pod complex as a focus for heritage renewal

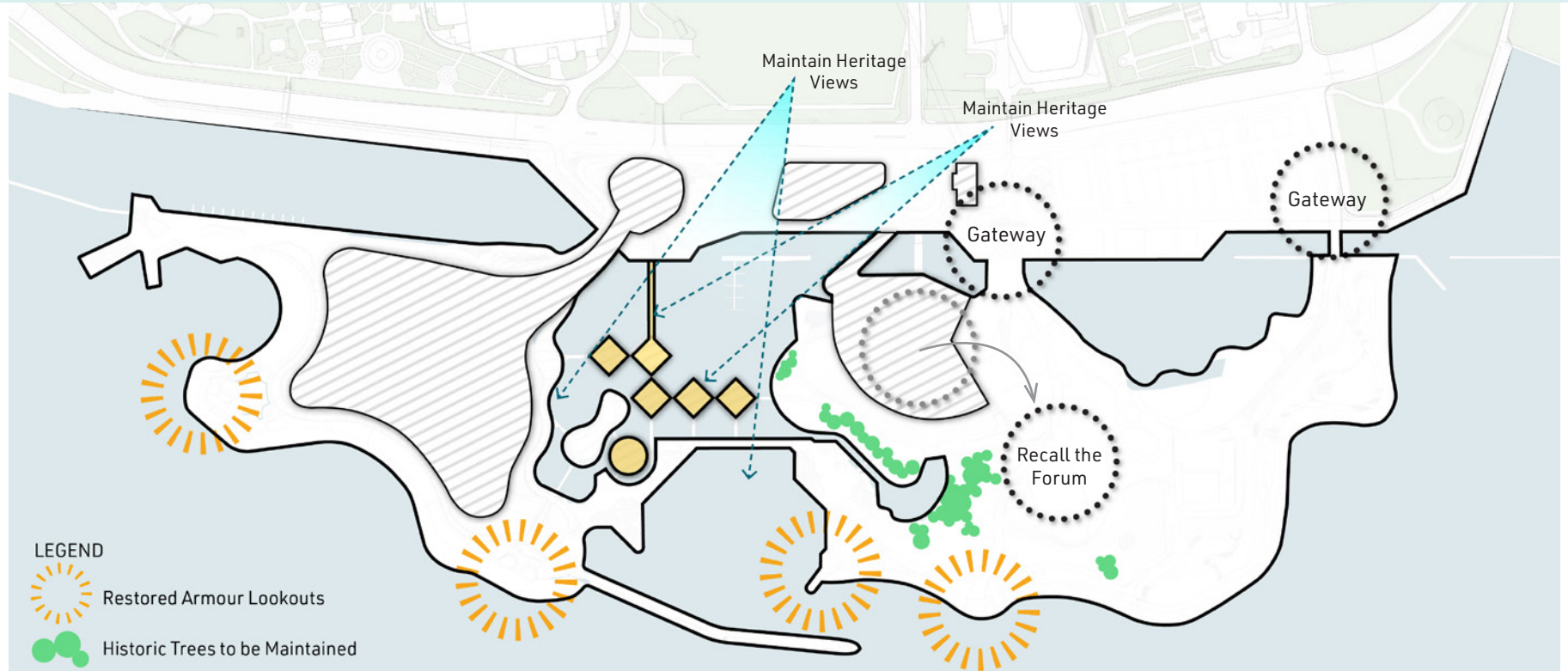

*General treed areas, specific impacts TBD.

Embracing the Site's Heritage

Protecting the Pods and Cinesphere



Re-interpreting Original Design Features



Celebrating Hough's Influence



Re-interpreting Original Design Features at Ontario Port



Conceptual design, subject to change.

Re-introducing the Children's Play Village



Indigenous Place Keeping

This plan illustrates possible concepts for potential design elements informed by Indigenous community engagement.

Sample of Indigenous Design Concepts/Principles

Inclusion of native trees and plant species

- Working with, not against nature. e.g., creation wetlands/floodlands
- The use of plants (e.g., water lilies) to filter out toxins in water
- Replace impervious with pervious material where possible
- The sharing/teaching of Traditional Ecological Knowledge (TEK)
- Leaving space for the natural world/wildlife habitat
- Linguistic diversity; inclusion of Indigenous languages

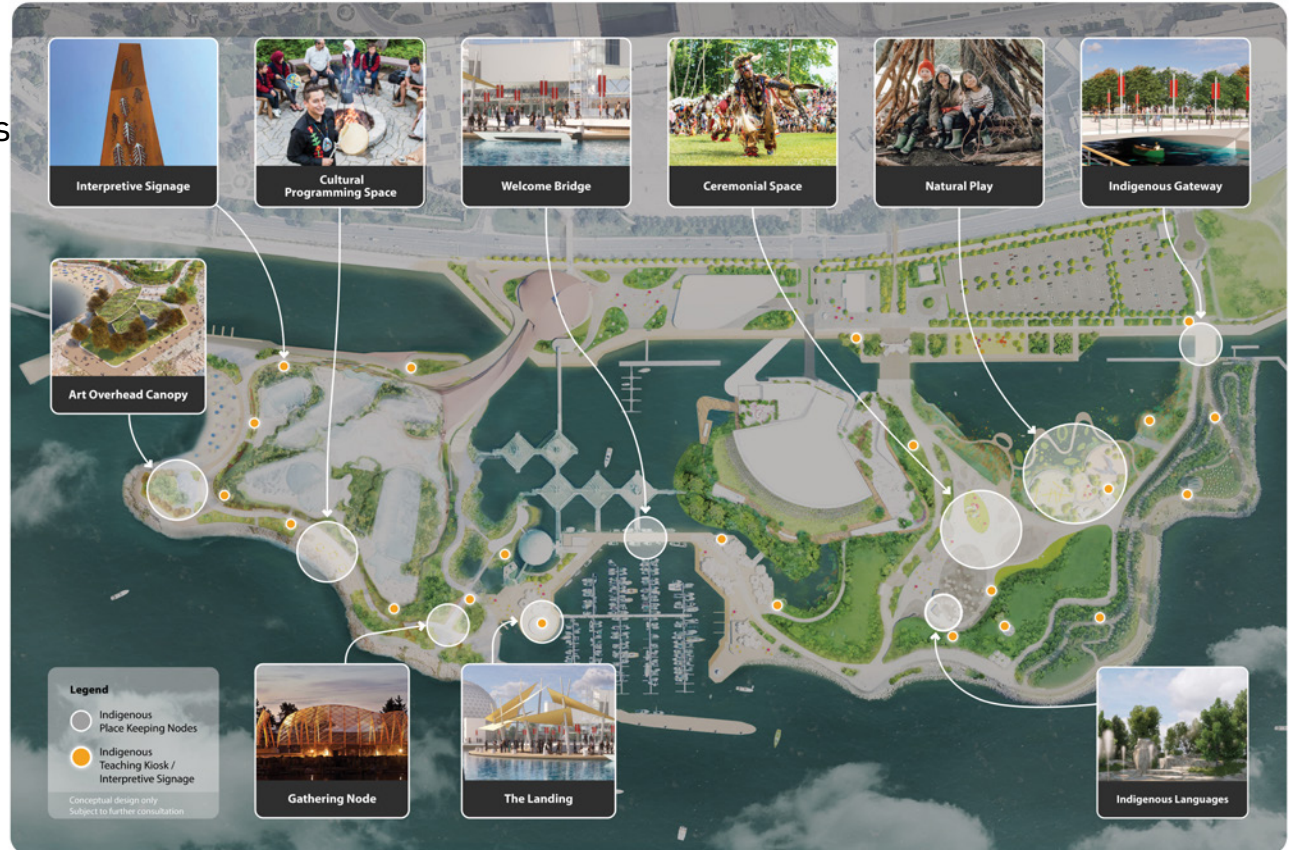

Structuring Element #4:

Enhance long-term resilience, environmental performance and sustainability



Proposed Shoreline Improvements



Regrading and Surface Improvements

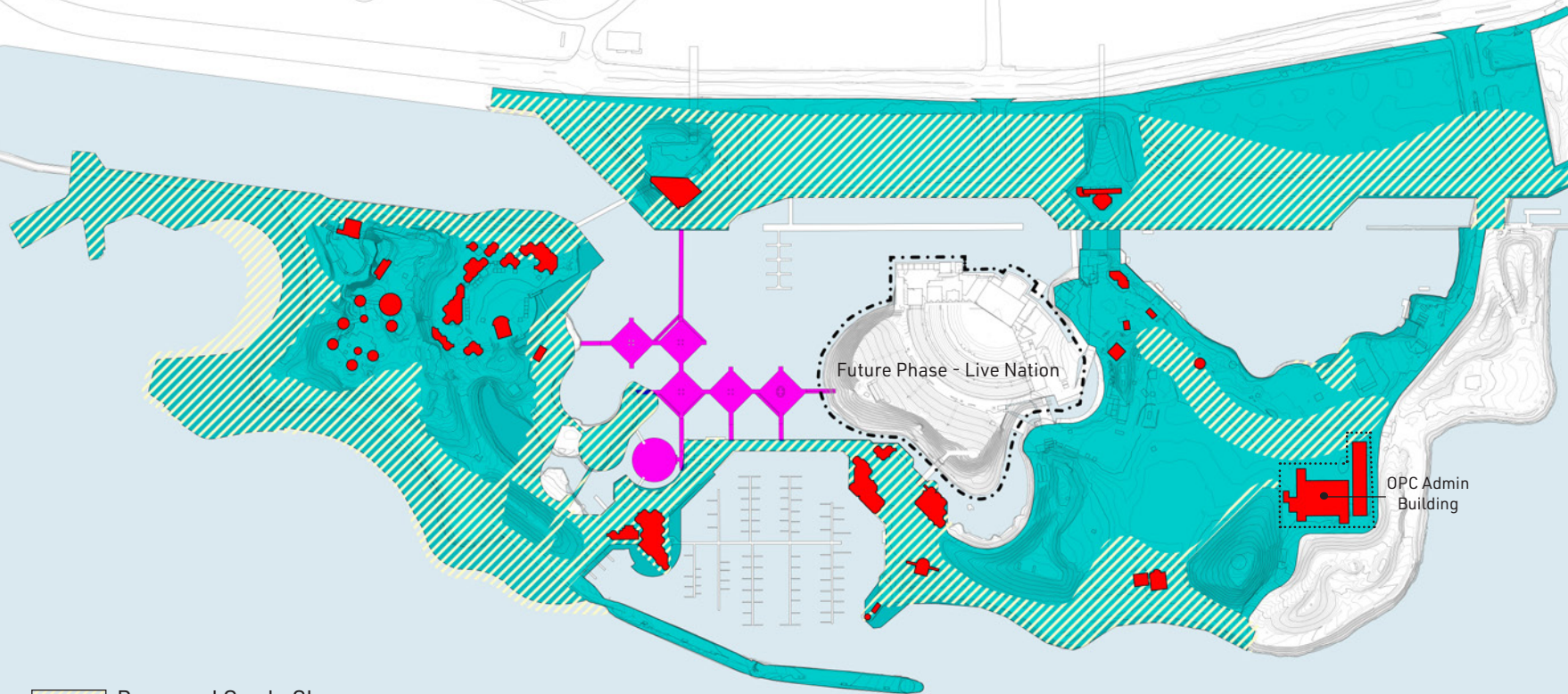

- Proposed Grade Change
- Proposed Surface Treatment
- Proposed Building Demolition
- Proposed Building Retention

NOTE: OPC Admin Building to be demolished as part of a future phase.

NOTE: Site impacts of Live Nation are not represented as it will be in a future phase of development.

Improving Water Quality at Brigantine Cove



Conceptual design, subject to change.

Thickened and Elevated South Shoreline



Conceptual design, subject to change.

Proposed Wetland Innovation Zone



Structuring Element #5:

Upgrade the public spaces and create new and expanded waterfront parks



Ontario Plaza: Creating a new Public Gathering Space



East Island: Re-imagine the Forum as a Public Space



West Island: Proposed Public Beach, Promenade Plaza, & Swimming Pier



West Island: Proposed Public Gathering Spaces and Waterfront Promenade



Structuring Element #6:

Deliver exciting programming year round

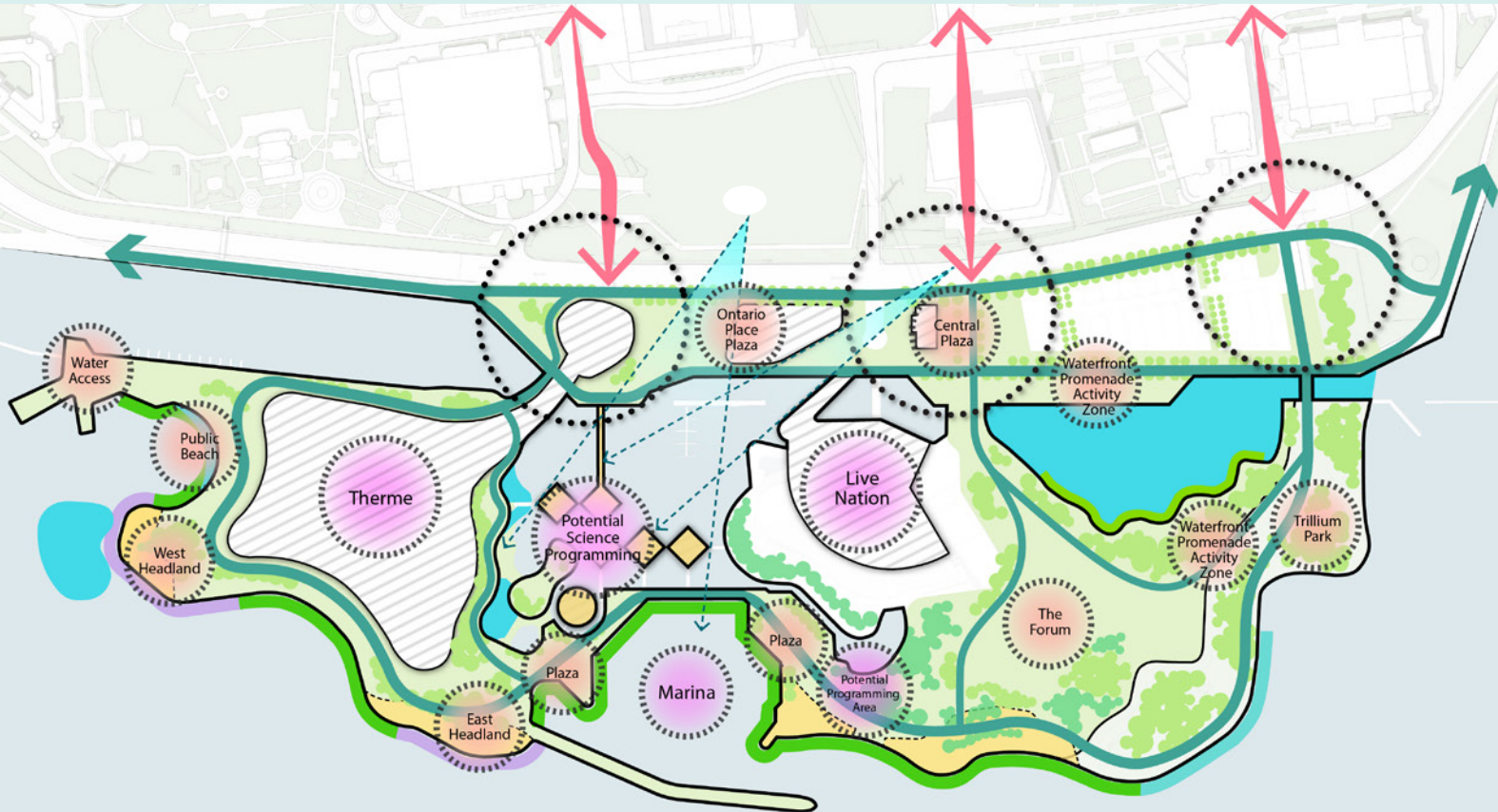

Supporting Amenities



Public Washroom

Supporting Amenities



Public Washroom



Public Changeroom



Supporting Amenities



Public Washroom





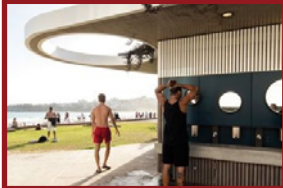

Public Changeroom



Food & Concession

A Range of Programming Types



-  Water Feature
-  Small Watercraft Recreation
-  Play Area
-  Other public gathering amenity

Therme Canada | Ontario Place



- Water based recreation in a year round botanical environment
- Wellness focused: Healthy food and beverage, relaxing/restful environment, connecting with nature
- Accessible, Affordable, Sustainable

Program Overview



Main Building



Bridge



Welcome Pavilion

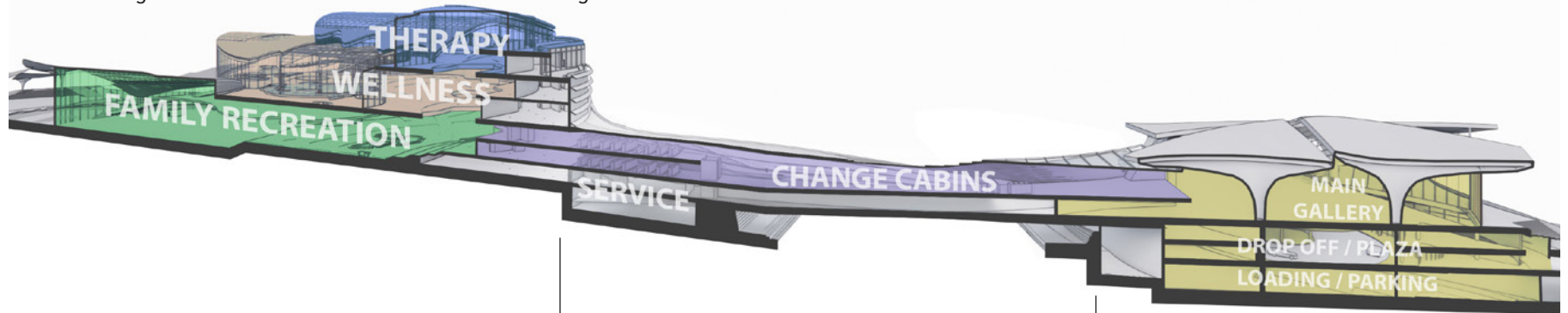

Main Building

Bridge

Welcome Pavilion

Program Overview: Main Building

Family Recreation



66%
of guests

Indoor/Outdoor Pools
Waterslides
Wave Pool
Children's Play
Water Based Exercise Classes
Lounge Chairs
Healthy Food & Beverage
Mineral Baths
Steam Rooms
+16 Zone

Wellness



21%
of guests

Indoor/Outdoor Pools
Healthy Food & Beverage
Exercise Classes
Lounge Chairs
Mineral Baths
Themed Saunas
Steam Rooms
Personal Care Services

Therapy



13%
of guests

Indoor/Outdoor Pools
Healthy Food
& Beverage
Exercise Classes
Lounge Chairs
Mineral Baths
Steam Rooms
Personal Care
Services

Number of
Daily Guests

14,000
PEAK
WEEKEND
DAY

8,250
TYPICAL
WEEKEND
DAY

4,250
TYPICAL
WEEKDAY

Main Building: Uses and Facilities



Family Recreation: Waterslides



Wellness: Mineral Baths



Family Recreation: Indoor/Outdoor Pool



Therapy: Outdoor Rooftop Pool and Terrace

West Island: Overview of Public Realm

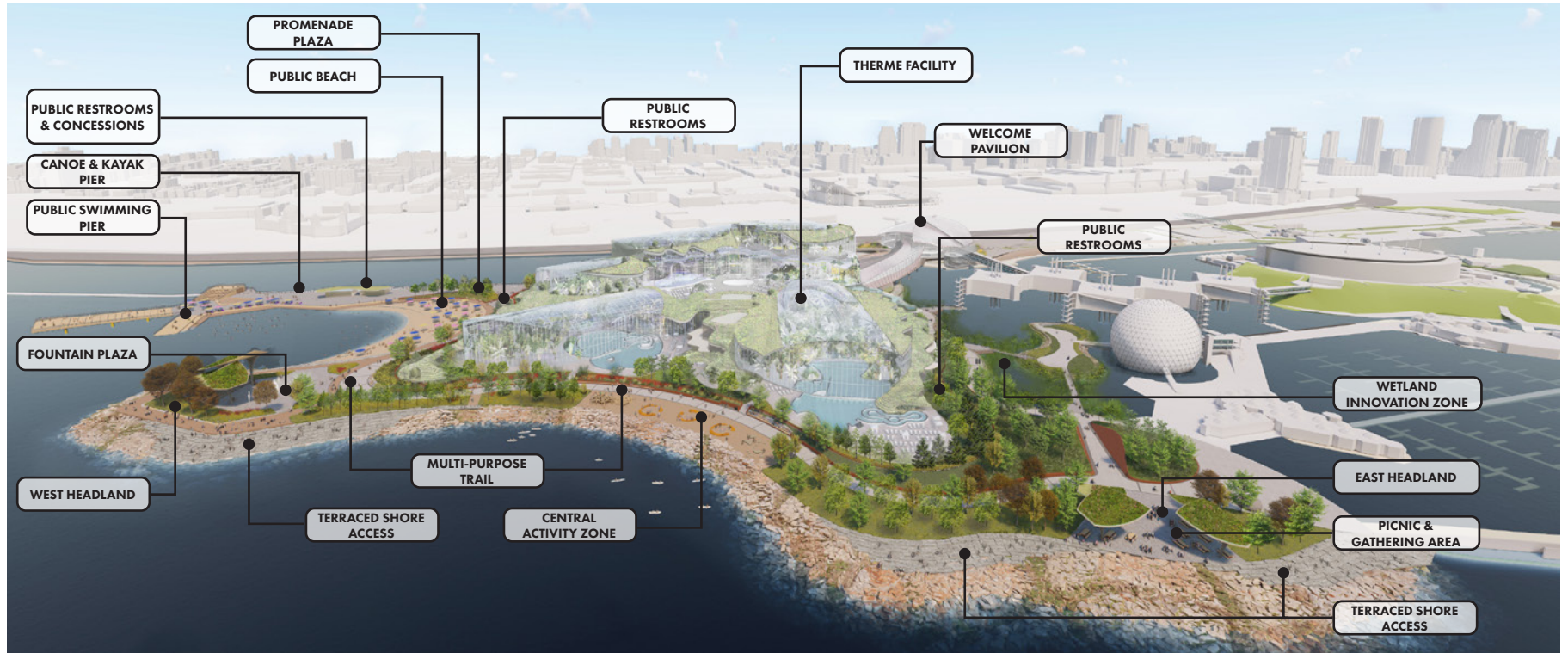

Science Programming (Future Application)

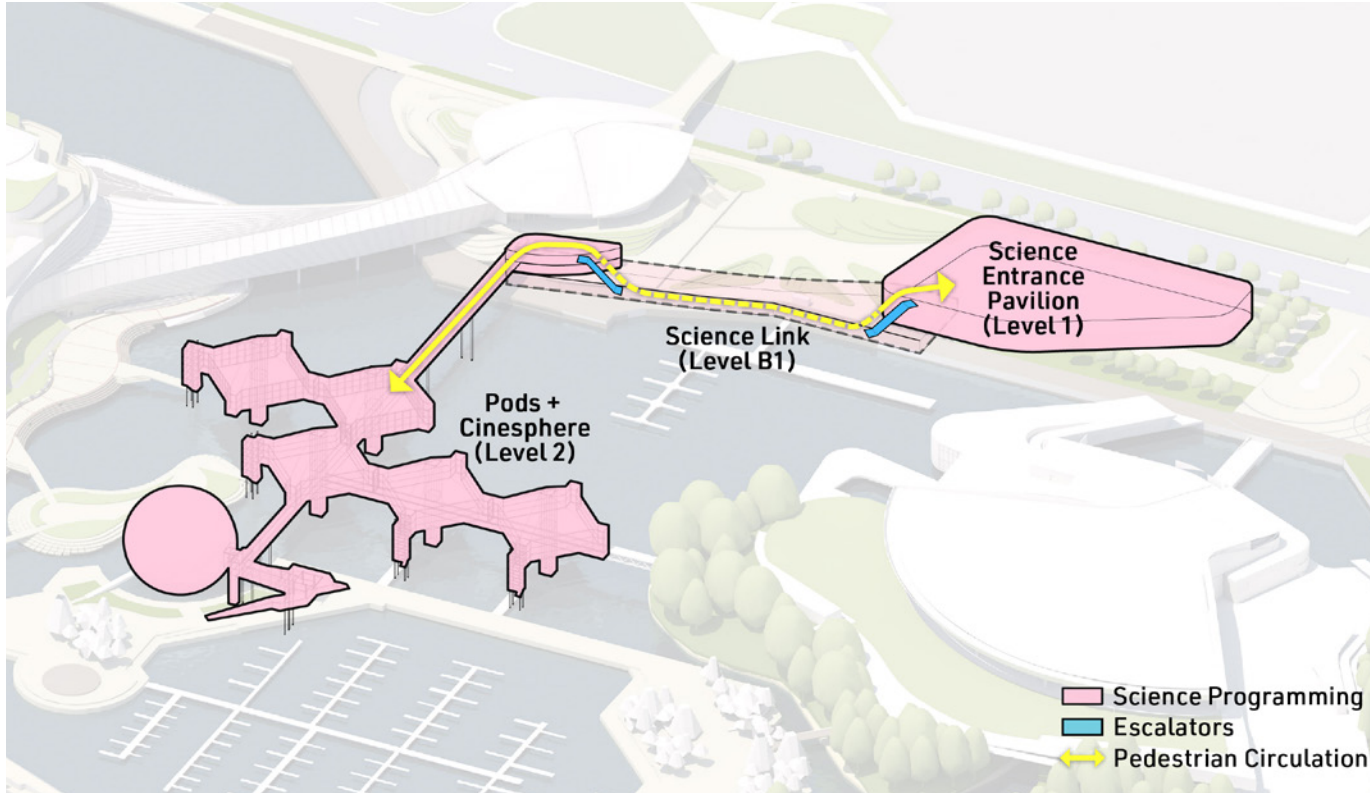

Source: Ontario Science Centre



Source: Ontario Science Centre

All-Season Amphitheatre (Future Application)



THANK YOU

